

**TRAFFIC CONTROL DEVICES
MANUAL FOR WORK ZONES**

Section:
**CHANNELIZATION &
DELINEATION DEVICES**

Subject:
BARRICADES

APPLICATION

The primary function of barricades is to delineate a work area in or near the travelled portion of a roadway and to block off a portion or all of a lane or roadway where closures become a necessity. Barricades will not be used to channelize traffic.

STANDARD BARRICADE

The Standard Barricade is a portable device having three panels with reflective orange and black stripes. Each barricade panel must be 24 cm wide and 240 cm long. The orange and black stripes must be at least 15 cm wide. Barricades with stripes that begin at the upper right side and slope downward to the lower left side are to be designated as "right" barricades (CS-12R).



Barricades with stripes that begin at the upper left side and slope downward to the lower right side are to be designated as "left" barricades (CS-12L).



Markings for the top barricade panels will slope downward at an angle of 45 degrees in the direction traffic is to take.

The top rail of the barricade may be replaced with a CS-27 rail signifying to keep left or right.



Regulatory or warning traffic signs may be affixed to barricades to provide additional information to the motorist regarding the road closure.

A typical plan of the Standard Barricade is shown on the next page.

Section:
CHANNELIZATION &
DELINEATION DEVICES

Subject:
BARRICADES

STANDARD BARRICADE

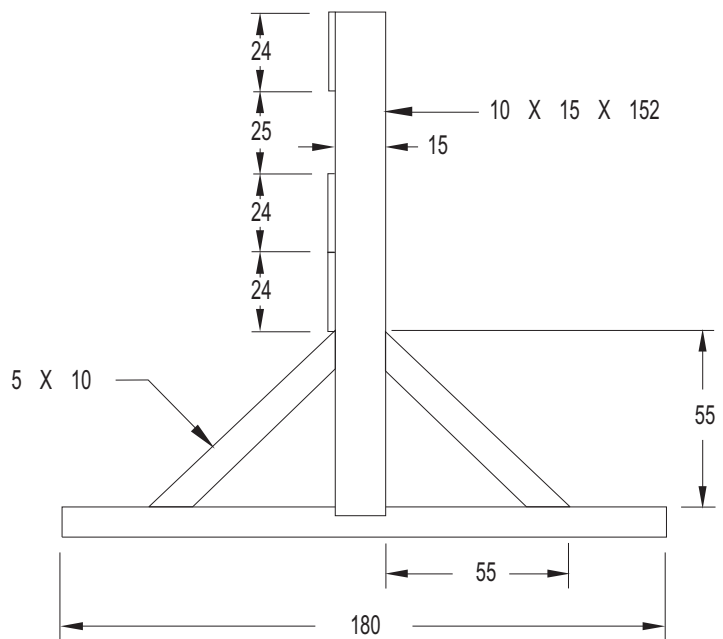
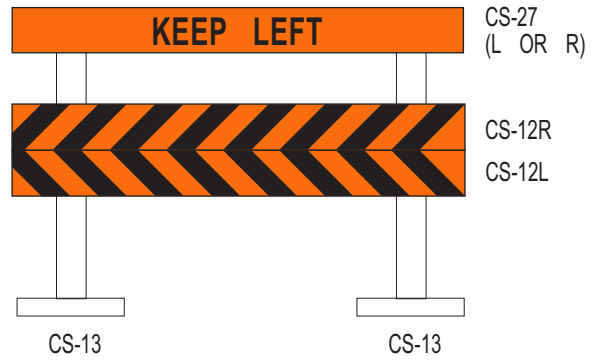
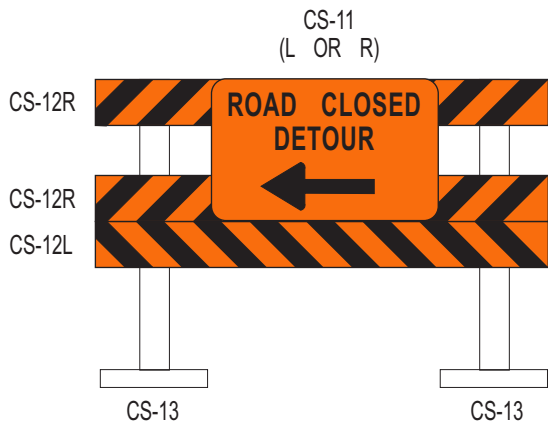

ALL DIMENSIONS IN CENTIMETRES

CS-13

Section:**CHANNELIZATION &
DELINEATION DEVICES****Subject:****BARRICADES****PORTABLE BARRICADE**

The Portable Barricade is light and easy to handle, store and transport. The intent is to use this type of barricade for short term road closures such as a washout. The barricade consists of one rail with reflective orange and black stripes.

The stability of portable barricades may be enhanced with the use of sandbags provided they are placed on or close to the barricade base.

PORTABLE BARRICADE**Date**

2009-08-05

Page

3 of 3